

Self-priming pump. Efficient flow

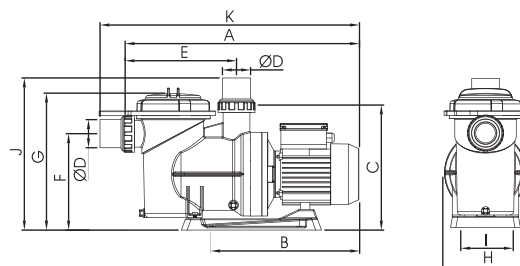
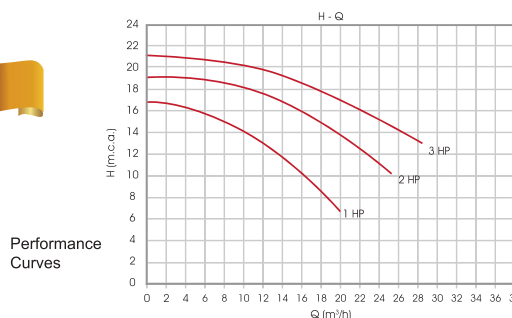

- The **Marathon Max** pump is built to be quiet, durable and reliable.
- The motor materials are rustproof, with a stainless steel motor shaft and sealed bearings that never need lubrication. The thermoplastic housing is built to withstand extreme heat and resist corrosion.
- New **Marathon Max** can deliver cost benefits as it moves the same amount of water but consumes less energy than the previous model.
- It includes a pre-filter with a large strainer to prevent the entry of any foreign objects which could cause damage to the hydraulic parts of the pump.
- Large strainer basket extends time between cleaning.
- See-through lid makes inspections fast and easy.
- Options include a 316SS shaft for salt water. 230V and 60Hz motors as well as Thai, Australian and British connections.
- **TUV GS** Certified.

Its Hydraulic design moves water more efficiently and quietly than any other pump in its category,

Code	Model	H m.w.c	Flow m³/h	Max dB (A)	A	B	C	D	E	F	G	H	I	J	K
CX-20401	1 HP Single Phase	10	16,4	65	611	388	321	50	285	246	355	224	152	392	663
CX-20402	2 HP Single Phase	12	23,0	70	646	423	321	63	285	246	355	224	152	392	698
CX-20403	3 HP Single Phase	14	35,0	70	686	463	321	63	285	246	355	224	152	392	738
CX-20404	1 HP Three Phase	10	16,4	65	611	388	321	50	285	246	355	224	152	392	663
CX-20405	2 HP Three Phase	12	23,0	70	656	433	321	63	285	246	355	224	152	392	708
CX-20406	3 HP Three Phase	14	35,0	70	686	463	321	63	285	246	355	224	152	392	738